

WAPPOO HALL

PLAN FILE 1
DRAWER 1
FOLDER 1
DRAWING No. 13

Stojo River

E L I O T S C U T

PARK

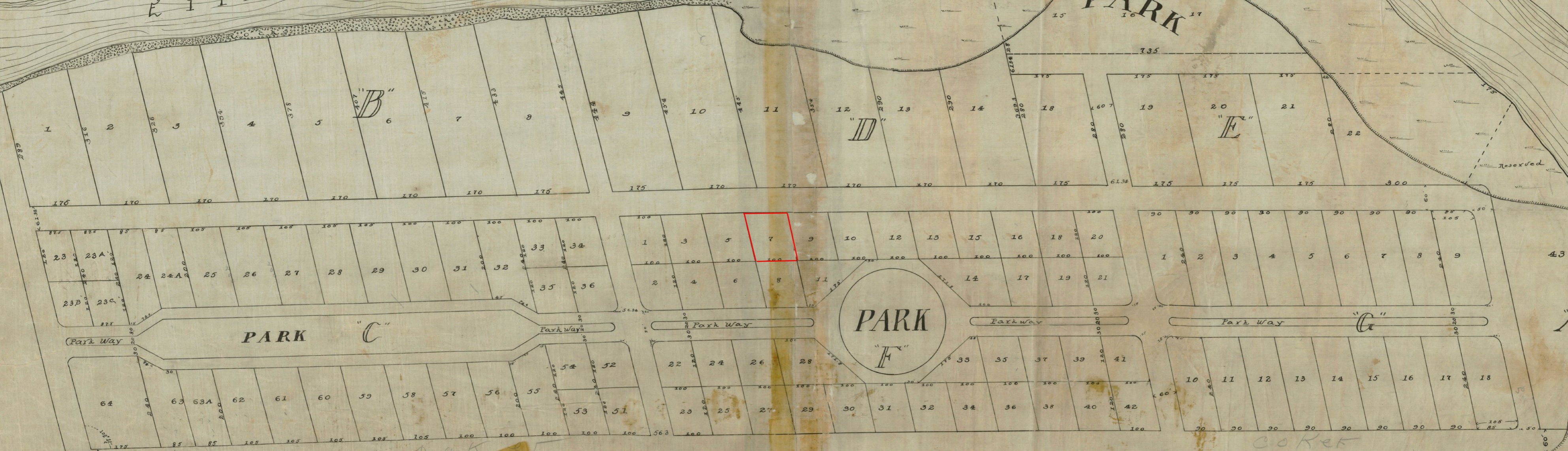

MAP
of
"Wappoo Hall"
Showing Change of Lay out in
Blocks C, E & G.
As originally Subdivided 1924 by G.M. Howe.
Scale: 1" = 100' Sept. 1925 By
G.M. Howe

R.M. C. Office, Charleston County, S.C.
Recorded October 1st 1925 at 11:AM
In Plat Book E Page 23 This
Copy furnished by W.C. Wilbur & Co.
Julius E. Cogswell, R.M.C.
per CLK AB